

POWERPACK SE SERIES

6/10 kVA

1:1
PHASE

ONLINE UPS



HOME/OFFICE



EMERGENCY



MEDICAL



INDUSTRY



DATA CENTER



TRANSPORT



UPS ONLINE



TOWER



POWER FACTOR



SERVICE



FEATURES

- High Frequency and True Double-Conversion
- DSP (Digital Signal Processors) Technology
- Input Power Factor Correction (PFC)
- Wide Input Voltage Range (110~300V)
- Output Power Factor 0.9
- Cold Start
- Auto Sensing Frequency
- ECO Mode Operation for Energy Saving
- Selectable Output Voltage via LCD
- 50Hz/60Hz Frequency Converter Mode Available
- Selectable Battery Low Voltage via LCD
- Power-On Self Test
- Advanced Battery Management (ABM)
- Short Circuit and Overload Protection
- Automatically Charging Battery at UPS Off Mode
- Fan Speed Auto Control when Load Varies
- Generator Compatible
- Standard RS232 Communication Port
- USB/SNMP Communication Port (Optional)
- Emergency Power Off (EPO) (Optional)
- Extension Battery Bank (Optional)
- Manual Bypass
- N+X Redundancy Parallel (Optional)

DETAILS

1. Input-Output Terminal
2. Input Breaker
3. Battery Breaker
4. Maintenance Switch
5. Fan
6. Battery Temperature Sensor
7. Parallel Card (Optional)
8. EPO
9. RS232
10. USB (Optional)
11. SNMP/AS400 (Optional)
12. BAT_NTC (Optional)

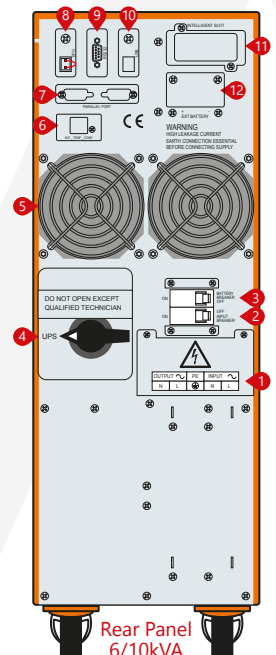

Rear Panel
6/10kVA



POWER
FORLIFE

Aytemiz
MAKELSAN®
Uninterruptible Power Supplies

| MODEL | | | |
|-----------------------------------|--|---------------------|----------------------|
| Power Watt | | 6kVA / 5400W | 10kVA / 9000W |
| INPUT | | | |
| Related Voltage | 208V / 220V / 230V / 240 VAC | | |
| Voltage Range | Half Load (110-300) ±5 VAC, Full Load (160-300) ±5 VAC | | |
| Frequency | 40 ~ 70 Hz (Auto Sensing) | | |
| Power Factor | ≥0.99 | | |
| Bypass Voltage Range | 160V - Rated Output Voltage +32V | | |
| OUTPUT | | | |
| Voltage Range | 208V / 220V / 230V / 240 VAC (Setting Available via LCD) | | |
| Voltage Regulation | ±1% | | |
| Frequency | 45 ~ 55 Hz or 55 ~ 65 Hz (Synchronized Range); 50 / 60 Hz ±0.1 Hz (Battery Mode) | | |
| Waveform | Pure Sine Wave | | |
| Crest Factor | 3:1 | | |
| Harmonic Distortion | ≤2% (Linear Load); ≤5% (Non-Linear Load) | | |
| Transfer Time | AC Mode to Battery Mode: 0ms Inverter Mode to Bypass Mode: 0ms | | |
| Overload Capability | 105% ~ 125%: Transfer to Bypass after 3min 125% ~ 150%: Transfer to Bypass after 30sec >150%: Transfer to Bypass after 100ms | | |
| EFFICIENCY | | | |
| AC Mode | ≥92% | | |
| Battery Mode | ≥91% | | |
| ECO Mode | ≥98% | | |
| BATTERIES | | | |
| DC Voltage | 192V-240V | | |
| Inbuilt Battery | 16-22 x 7-9Ah | | |
| Charge Current | Standard Model | 3.5A | |
| | Long Time Model | 1A / 3.5A / 7A | |
| Typical Recharge Time | 8 hours Recover to 90% Capacity | | |
| ALARMS | | | |
| Utility Failure | Beep / 4sec | | |
| Low Battery | Beep / 1sec | | |
| Overload | Beep Twice / 1sec | | |
| UPS Fault | Long Beep | | |
| ENVIRONMENTAL | | | |
| Humidity | 20-90% RH @ 0-40°C (Non-Condensing) | | |
| Noise Level | ≤50 dB (1m) | | |
| COMMUNICATION | | | |
| RS232 (Standard) / USB (Optional) | Supports Windows® 98/2000/2003/XP/Vista/2008/Windows® 7/8/10 | | |
| SNMP (Optional) | Power Management from SNMP Manager and Web Browser | | |
| DIMENSIONS & WEIGHT | | 6kVA | 10kVA |
| Dimensions WxDxH (mm) | 262 x 650 x 735 | | |
| Packaging Dimensions WxDxH (mm) | 440 x 720 x 940 | | |
| Net Weight (kg) | 64.1 | 70.8 | |
| Gross Weight (kg) | 72.2 | 78.9 | |

Aytemiz-Makelsan reserves the right to change or modify product design, construction, specifications, or materials without prior notice and without incurring any obligation to make such changes and modifications on Aytemiz-Makelsan products previously or subsequently sold. Aytemiz-Makelsan does not guarantee the items of the accuracy and completeness.